

TOLERANCE UNLESS OTHERWISE SPECIFIED		
FRACTIONS ±	DECIMALS ±	DEGREES ±
DRAWN <b>JH</b>	CHECKED	APPROVED <i>[Signature]</i>

TITLE <b>NETWORK SCHEMATIC</b>	
1st REF. <b>AA USED TILL 2/83</b>	DRAWING # <b>M11C9004</b>

DATE <b>820928</b>	SCALE <b>NA</b>
DIMENSIONS <b>SAE</b>	<b>1 OF 1</b>

REVISION
<b>REDRAWN ON CAD 900102</b>

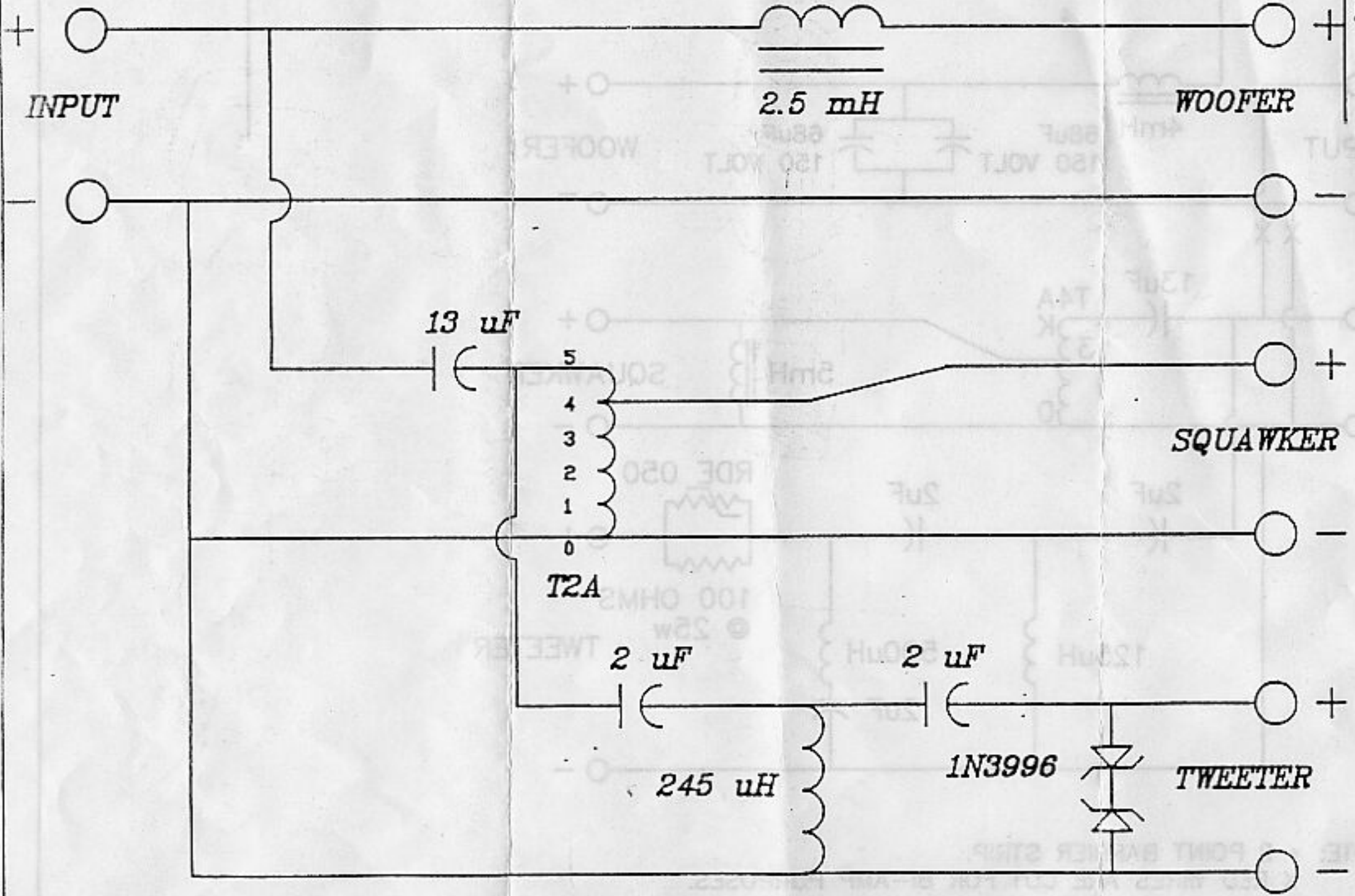



KLIPSCH AND ASSOC., INC.  
P.O. BOX 688, HOPE ARK. 71801



TOLERANCE UNLESS OTHERWISE SPECIFIED

FRACTIONS ± 1/32	DIGITALS ±	DEGREES ±
DRAWN	CHECKED	APPROVED

TITLE  
AUTOFORMER (T2A)

DATE 801002

SCALE FULL

1st REF.  
3110-A

DRAWING #  
P11FB001

DIMENSIONS SAE

1 of 1

CC

REVISION  
0.67 WAS  
0.8 . NOTE  
ADDED.  
880923

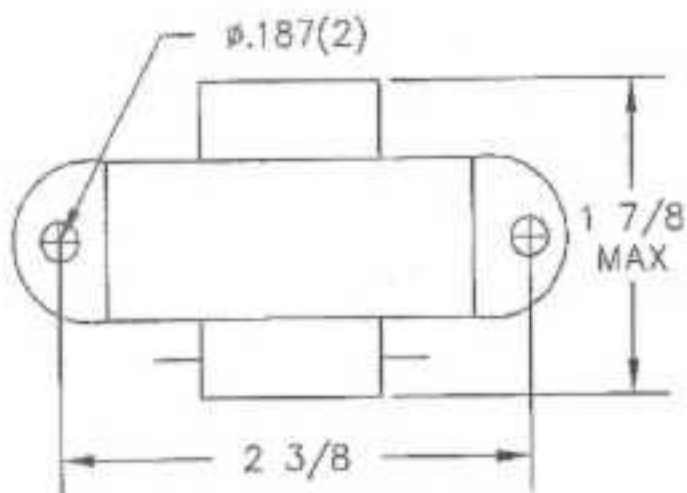
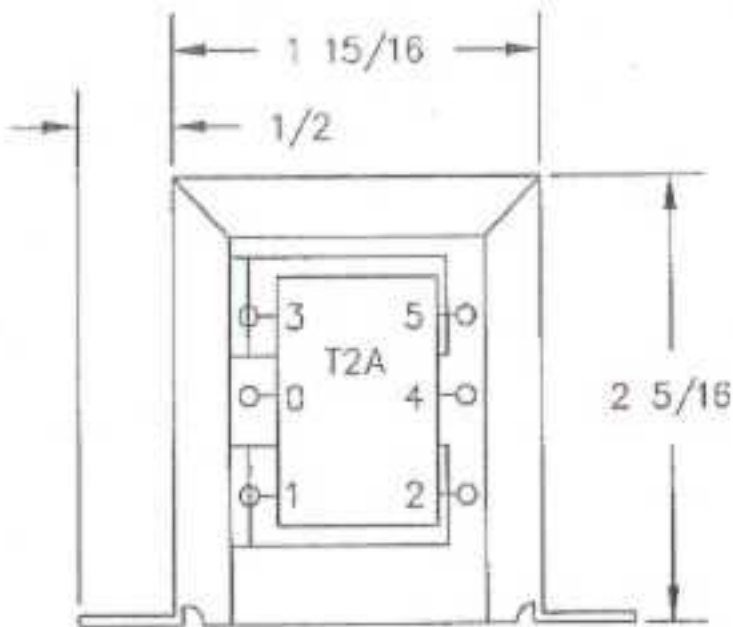

SPECIFICATIONS

WAX IMPREGNATED WINDINGS  
WINDING TO BE TIGHT ON CORE  
ALL TERMINAL LOOPS TO BE  
PRE-SOLDERED BY VENDOR

PINS	-dB	L (mH) ±15%	R (OHMS) ±10%	Vout (*)
0-1	12	2.8	--	2.51
0-2	9	5.8	--	3.55
0-3	6	11.4	--	5.01
0-4	"3"	21.2	--	6.80
0-5	0	--	0.67	10

Vout IS MEASURED WITH 10 VAC  
AT 1000 Hz. APPLIED TO PINS 0-5  
WITH PIN 0 AS GROUND.